

40V^{Li-ion} max + 40V^{Li-ion} max
XGT X2
 80V^{max}

40Vmax
 series
 movie



40Vmax
 mechanism
 movie



This movie was filmed
 in Japan.
 Models and specs may
 vary by country.

Cordless Hammer Series

40V^{Li-ion} max + 40V^{Li-ion} max
XGT X2
 80V^{max}



Demolition Hammer
 HM002G



Rotary Hammer
 HR006G



XGT
 40V^{Li-ion} max

Demolition Hammer
 HM001G



Rotary Hammer
 HR005G



Combination Hammer
 HR001G / HR002G / HR003G / HR004G



Makita Cordless Demolition Hammer
 HM002G Adapted for SDS-MAX bits

Satisfy Professional's Needs



40V^{Li-ion} max + 40V^{Li-ion} max

XGT X2
 80V^{max}

Cordless / More powerful than corded tools

Accessories

Dust extractor attachment set

without Vacuum hose set
 Part No. 199143-4



with Vacuum hose set
 Part No. 199144-2



Side handle

Part No. 135269-8



Grease vessel set
 for bit

Part No. 194683-7
 198993-4 (EU)



Charging Time Reference

40V ^{Li-ion} max	DC40RA Fast Charging	DC40RC
	DC40RB	DC40RB
BL4020 2.0Ah	22min	30min
BL4025 2.5Ah	28min	38min
*BL4040 4.0Ah	45min	67min
*BL4050F 5.0Ah	50min	85min

*1 Recommended battery

Cordless Demolition Hammer

HM002G Adapted for SDS-MAX bits

- Variable Speed
- SDS-MAX Shank
- Constant Speed
- Soft Start
- Built-in Job Light
- Carrying Case

Impact Energy	EPTA-Procedure 05/2009: 20.9 J
Blows Per Minute (BPM)	950 - 1,900
Shank Diameter	18 mm (11/16")
Sound Pressure Level	92 dB(A)
Sound Power Level	103 dB(A)
Vibration Level	Chiselling Function w/ Side Handle: 8.0 m/s ²
Dimensions (L x W x H)	w/ BL4040: 574 x 146 x 324 mm (22-5/8 x 5-3/4 x 12-3/4")
	w/ BL4050F: 574 x 156 x 344 mm (22-5/8 x 6-1/8 x 13-1/2")
Net weight	12.0 - 13.3 kg (26.5 - 29.3 lbs.)

Standard Equipment : Bull Point, Grease for bit, Side Handle, Wireless Unit (country-specific), Wireless Unit Adapter (country-specific), Battery, Charger

The weight may differ depending on the attachment(s), including the battery cartridge. The lightest and heaviest combination, according to EPTA-Procedure 01/2014, are shown in the table.

Items of standard equipment and specifications may vary by country or area.

Makita Corporation

3-11-8 Sumiyoshi-cho, Anjo, Aichi, 446-8502 Japan

PRINTED IN JAPAN 202103



40V^{Li-ion} max + 40V^{Li-ion} max **XGT X2** 80V^{max}



Impact energy
[EPTA-Procedure 05/2009]
20.9
Joule

Work amount (for 5 minutes)

Concrete with compressive strength of 40N/mm²
BL4040 x2 (on a full battery charge)

HM002G	115
AC tools	100

small large

Anti-Vibration Technology

Vibration level at main handle

8.0m/s²



AVT

Active dynamic vibration absorber moves in the opposite direction to the drive piston to reduce vibration.

Vibration absorbing housing isolates handle and motor.

Chipped concrete and measured the amount of concrete removed

Concrete with compressive strength of 40N/mm²
BL4040 x2 (on a full battery charge)

about **13 min**

High power and Low vibration



BL MOTOR High power brushless motor

SOFT NO LOAD

Suppression of motor speed during no-load

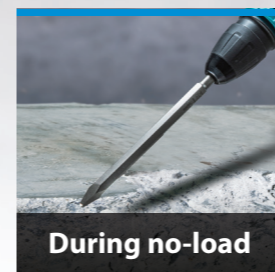

AWS Auto-start Wireless System

Connects to compatible vacuum cleaner with Bluetooth. The vacuum cleaner automatically runs while the switch is on.

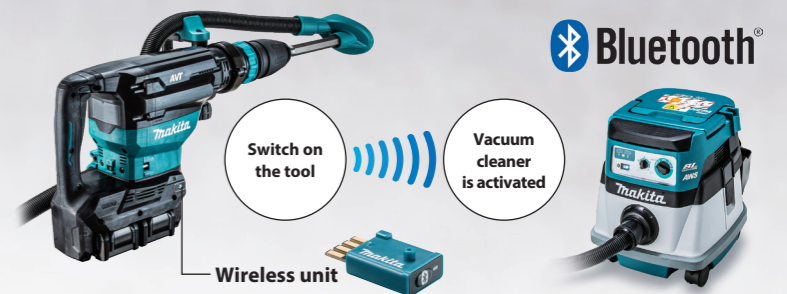

XPT
eXtreme Protection Technology



Adapted for SDS-MAX bits

12 bit angle settings

Twin LED job lights



Variable speed control dial



Slide lever for trigger lock-on / lock-off

Trigger lock-on/lock-off can be set simply by pushing the slide lever:
 • For lock-on of the trigger, pull and hold the trigger, then push the slide lever.
 • For lock-off of the trigger, push the slide lever without pulling the trigger.